



MANUAL  
**INTEGRA II**  
Insert



# TABLE OF CONTENTS

---

## AUSTROFLAMM INTEGRA II FREESTANDING

### INSTALLATION AND ASSEMBLY

Austroflamm: An Overview	3
Safety Precautions	4,5
Labels	6,7
Main Control Board	8
Parts Illustration	9,10
Specification/Capacity	11
Automatic Safety Functions	12
Assembly	13
Installation Instructions	14,15,16
A New Heating Philosophy	17

### PELLETS / GENERAL

What Are Pellets?	18
Storing Pellets	19

### OPERATING INSTRUCTIONS/FEATURES

Basic Operation	20
Starting Procedure	21,22

### MAINTENANCE / CLEANING

Maintenance and Cleaning	23,24,25
Faults/Causes/Solutions	26,27

### QUALITY / WARRANTY

Key Word Abbreviations	28
Warranty	29
Warranty Registration	30

## SAFETY NOTICE

**IF THIS WOOD PELLET STOVE IS NOT PROPERLY INSTALLED, A HOUSE FIRE MAY RESULT. FOR YOUR SAFETY, FOLLOW THE INSTALLATION DIRECTIONS. CONTACT LOCAL BUILDING OR FIRE OFFICIALS ABOUT RESTRICTIONS AND INSTALLATION INSPECTION REQUIREMENTS IN YOUR AREA.**

**PLEASE READ THIS ENTIRE MANUAL BEFORE INSTALLATION AND USE OF THIS WOOD PELLET FUEL-BURNING ROOM HEATER. FAILURE TO FOLLOW THESE INSTRUCTIONS COULD RESULT IN PROPERTY DAMAGE, BODILY INJURY OR EVEN DEATH.**

**SAVE THESE INSTRUCTIONS FOR FUTURE REFERENCE**

### WARNING

**This stove is not intended for use in commercial installations.**

**This stove should be installed by a certified service technician.**

---

## AUSTROFLAMM: AN OVERVIEW

---

### Portrait

Congratulations on your purchase of a quality Austroflamm wood pellet stove made by Rika. You are now a member of a group of over 100,000 Rika owners.

If you were not familiar with Rika before your purchase, please allow us to introduce ourselves:

RIKA was founded over 50 years ago in Micheldorf, Austria by Karl Riener and his family.

We appreciate quality and feel that our company manufactures some of the finest pellet and wood burning stoves available in today's marketplace. From a small company, specializing in hand made wrought iron products, grew a large, well known company known today as Rika Metallwarengesellschaft. Unique designs and emphasis on quality, performance and superior workmanship have made us a leading stove manufacturer in



Europe. State of the art processes, such as; robotic welding, laser cutting, and complete micro-processor control systems, allow us to produce a final product that we feel is unequalled.

In addition to pellet stoves, we are also known for our high-quality wood-burning stoves, wood-burning cookstoves, Free

standing fireplaces and water heater units. Rika also produces a large variety of other metal products for international corporations. In 1988 Rika began to introduce its products into the United States under the trade name "Austroflamm". Our rapid growth in the U.S. is directly attributable to the quality and unique design of the Austroflamm line of pellet stoves. Our attention to these details has given us the nickname in the United States as the "Mercedes of the Pellet Stove Industry".

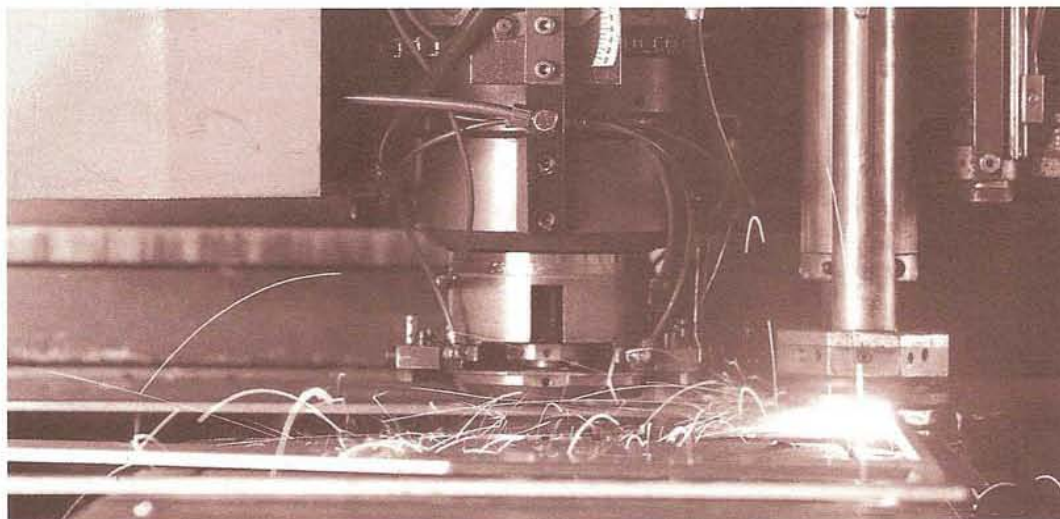

## SAFETY PRECAUTIONS

### READ THESE SAFETY PRECAUTIONS BEFORE INSTALLING OR USING STOVE

The Austroflamm Integra II Insert wood pellet stove must be properly installed in order to prevent the possibility of a house fire. For your own safety, you must adhere strictly to the installation instructions. Contact your local building officials to obtain a permit and information on any installation restrictions and inspection requirement in your area. Failure to follow these instructions could result in property damage, bodily injury or even death.

The word “stove”, as used in this manual, means the Austroflamm Integra II Insert wood pellet stove

The stove’s exhaust system works with negative combustion chamber pressure and a slightly positive chimney pressure. It is therefore imperative that the air intake and exhaust system be air tight and installed correctly.

### WARNING

**BURN WOOD PELLET FUEL ONLY!  
NEVER BURN ANY OTHER FUEL  
SUCH AS PAPER, SOLID WOOD  
OR CHARCOAL!**

When operated properly, the stove cannot be over fired. However, continuous operation at maximum burn may shorten life of the electrical components and is not recommended.



Do not use gasoline, gasoline-type lantern fuel, kerosene, charcoal lighter fluid or similar liquids to start or “freshen up” a fire in this stove. Keep these flammable liquids well away from this stove when it is in use.

Build-up of dust, soot, or creosote in the chimney connector and in the exhaust vent can cause a house fire. Although this will be minimal with correct operation, it is advisable to inspect the chimney connector and exhaust vent on a regular basis and clean if necessary.

Note: Disconnect power before performing any routine maintenance.

Ashes removed from the stove may be hot. Ash must be deposited in a metal container with a tight fitting lid. The closed ash container should be placed on a non-combustable surface and the ash should be cold pending final disposal.

The stove comes with a 7' to 8' grounded electrical cord. This cord should be connected to a standard 110 volt, 60 Hz electrical outlet. The approximate power requirement is 100 watts. The power supply cord must be routed to avoid contact with any of the hot or sharp exterior surface areas of the stove.



INSTALLATION AND ASSEMBLY

Avoid direct contact with stove while in use as surfaces are hot and may cause burns.

Never let unsupervised children around stove while in use as children may contact hot stove surfaces, which may cause burns.

Do not cook food, hot beverages or place anything on top of stove.

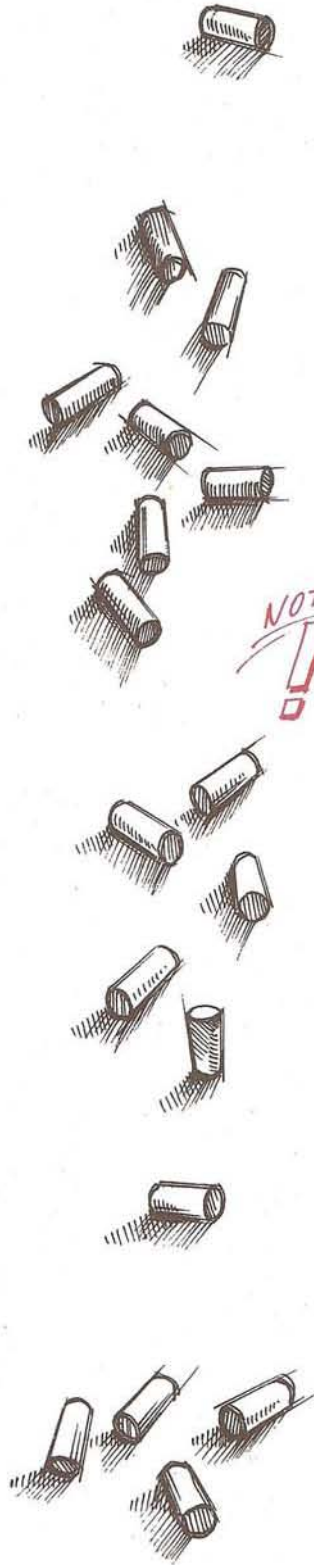

Burning with insufficient combustion air will result in the formation of soot, which will be deposited in the flue pipe and the heat exchanger. If the stove then vents through the wall, it will stain the outside of the house. This is a hazard in addition to being an inefficient and wasteful use of pellets. Check your stove frequently and adjust the combustion air as required.

The pellets burned in the stove are fed by an auger. This auger is driven by a high-torque motor. The auger is capable of causing serious injury to fingers. Keep pellets in the hopper at all times.

**The auger may start at any time when the stove is running! Keep hands and fingers away from auger at all times as contact with auger may cause personal injury.**

### **Safety testing**

Austroflamm Integra II Insert stoves have been independently tested and listed with OMNI Labs in Beaverton, OR., an accredited testing laboratory, in accordance with the specifications and procedures outlined in US 1482 for solid fuel room heaters, stating requirements for installation as a room heater. (The safety listing label is located on the back of the stove).

The stove is designed specifically for use with pelletized fuels only. It is tested and listed for residential installation according to current national and local building codes.

# OMNI SAMPLE LABEL FOR AUSTROFLAMM INTEGRA II

---

Insert

Insert

# MAIN CONTROL BOARD

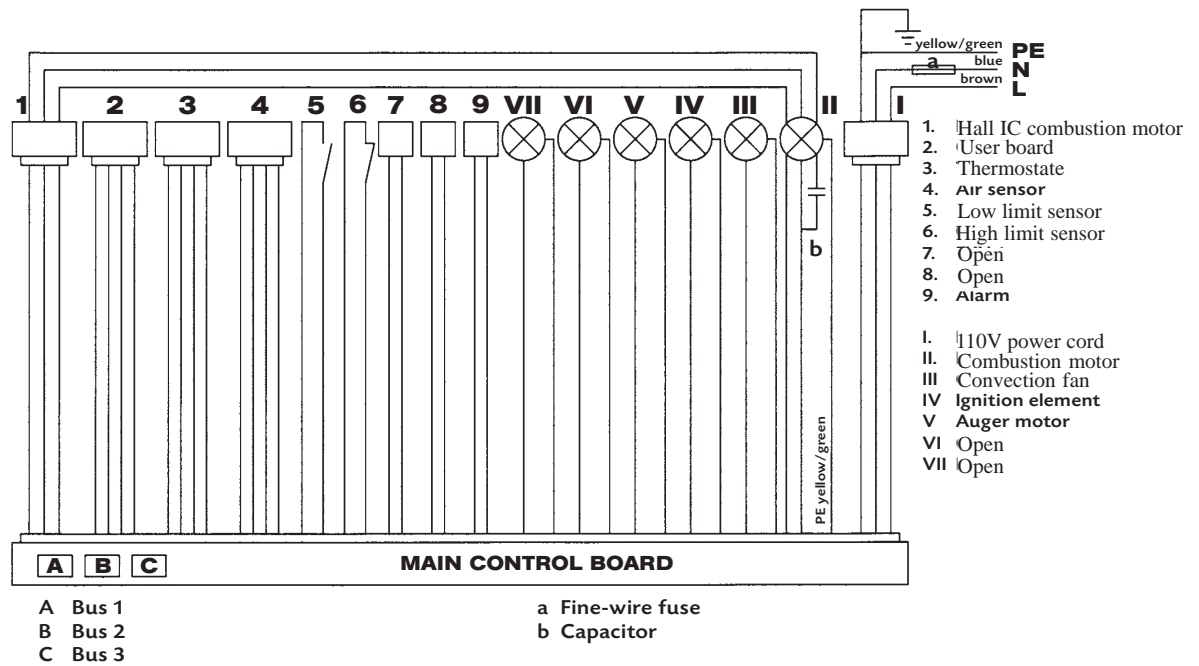
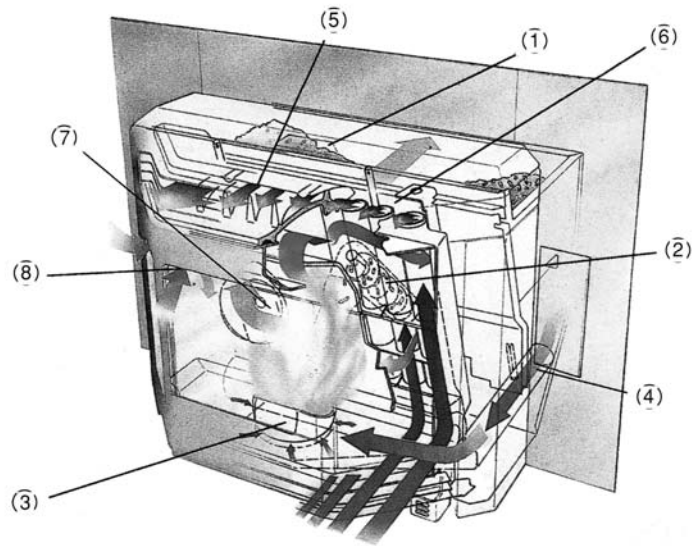

Diagram A

# Parts Illustration



**Fig. 1**

**Integra Pellet Stove System**

- |                                     |                                  |
|-------------------------------------|----------------------------------|
| 1 Hopper                            | 5 Heat exchanger forechamber     |
| 2 Auger                             | 6 Heated convection air          |
| 3 Firepot                           | 7 Combustion fan (3" connection) |
| 4 Air-intake with electronic sensor | 8 Glass airwash                  |

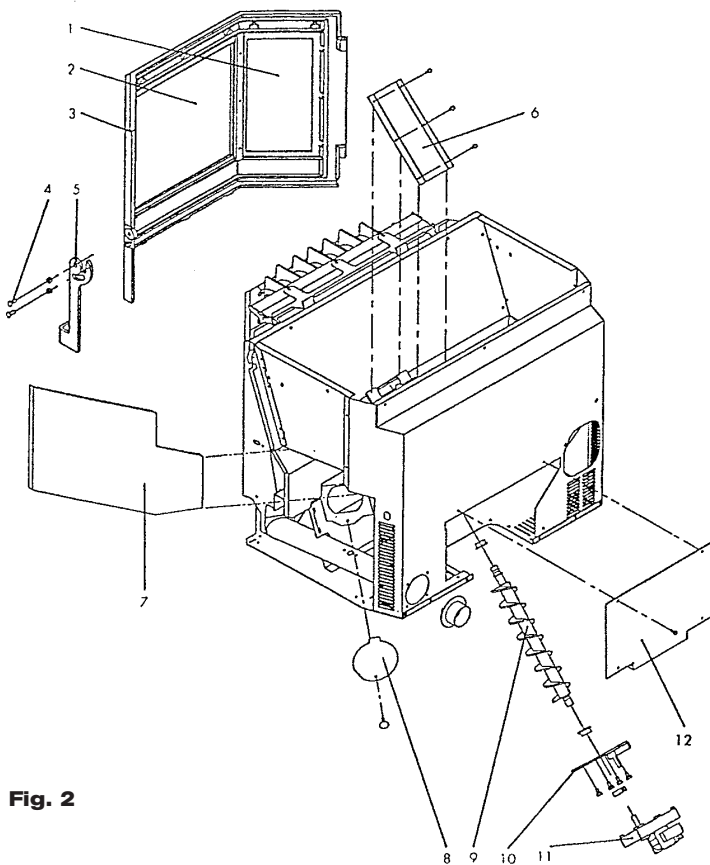

**Fig. 2**

**Parts Descriptions (1-12):**

**Figure 2**

1. Ceramic Side Glass
2. Ceramic Front Glass
3. Cast Iron Door
4. Door Handle Bolt
5. Door Handle
6. Auger Cover
7. Heat Shield
8. Rear Heat Exchanger Access Plate
9. Auger
10. Auger End Plate
11. Auger Motor
12. Rear Cover Plate

## Parts Descriptions (13-28):

**Figure 3**

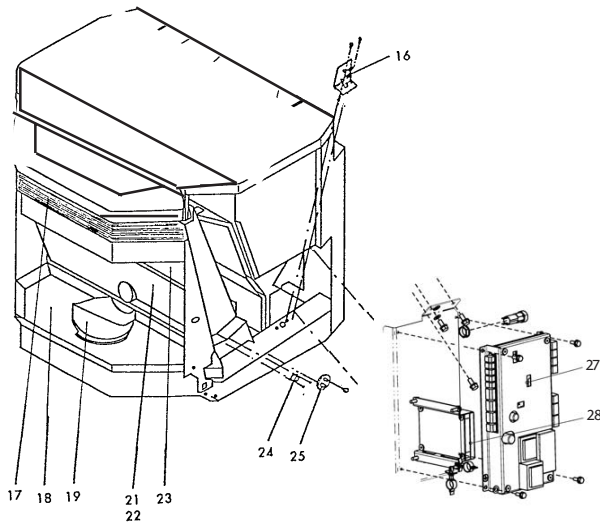

- 15. Hopper Cover
- 16. Air Sensor
- 17. Top Grill
- 18. Ash Pan
- 19. Burn Pot
- 21. Lower Cast Wall
- 22. Lower Cast Wall Gasket
- 23. Upper Cast Wall
- 24. High Limit switch
- 25. Adjustable Door Latch
- 27. Main Circuit Board
- 28. Tele-Control (Europe Only)

**Fig. 3**

## Parts Descriptions (29-40):

**Figure 4**

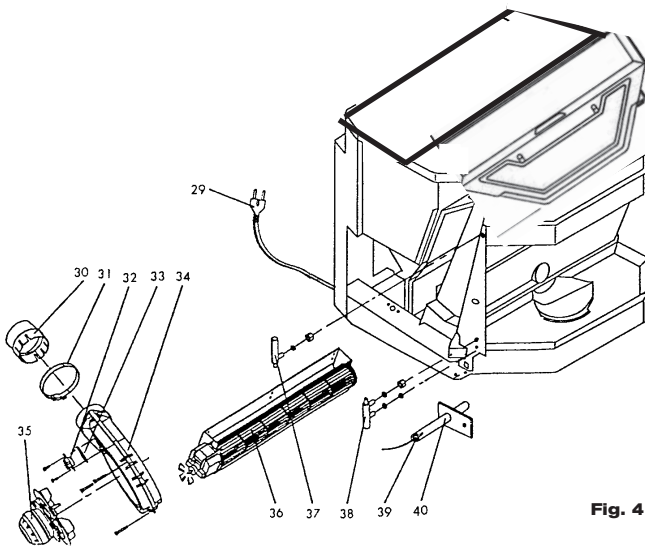

- 29. Power Cord
- 30. Flue Adapter
- 31. Connecting Band
- 32. Low Limit Switch
- 33. Low Limit Gasket
- 34. Combustion Motor Housing
- 35. Combustion Motor
- 36. Convection Fan
- 37. Upper Door Hinge
- 38. Lower Door Hinge
- 39. Ignitor Element
- 40. Ignitor Bracket

**Fig. 4**

# Specification/Capacity

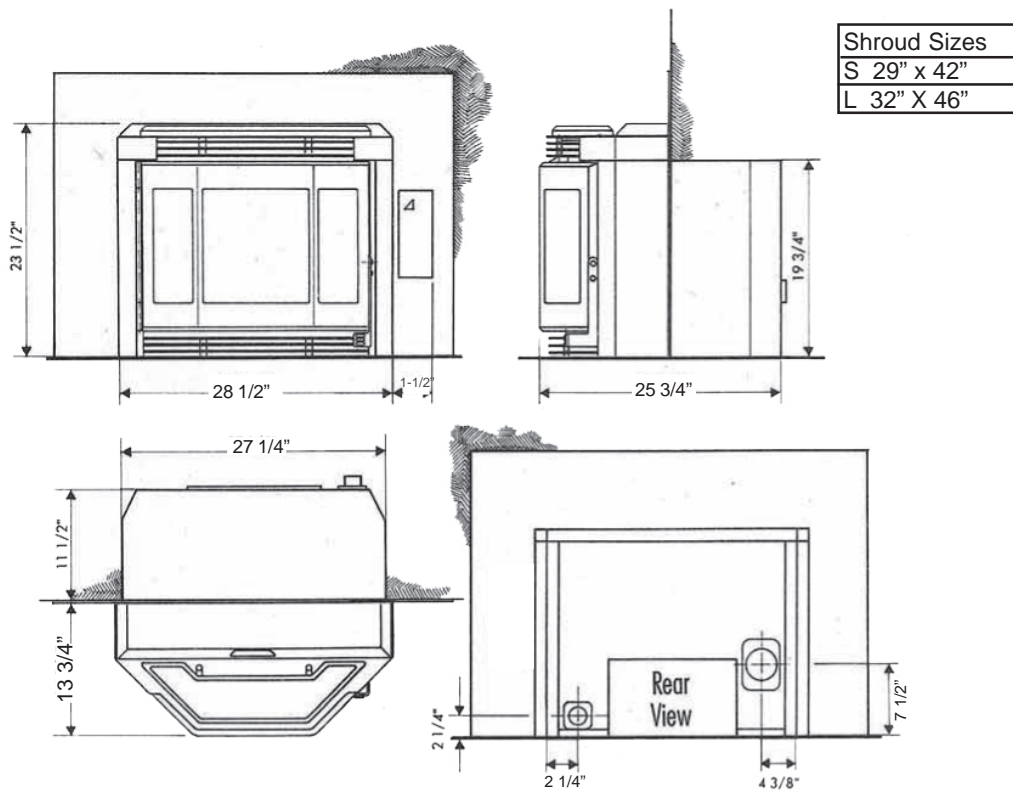

Height (inches) (Front)	37 1/2"
Width (inches) (Front)	28 1/2"
Depth (inches) (Total)	25 3/4"
Weight (pounds)	258 lbs.
Exhaust Outlet	3"
Heating capacity(BTUs)	7,000 - 44,000
Heating capacity(Square Feet)	2500
Fuel consumption(Pounds per hour)	1-5
Pellet Hopper capacity(pounds)	99
Powersupply	110 V, 60 Hz
Average electrical power consumption	< 100 W
Fuse	3,15 A
Rear Height	19 3/4"
Rear Depth into Fireplace	11 1/2"
Rear Width	27 1/4"

# AUTOMATIC SAFETY FUNCTIONS

---

## 1. AFTER A POWER FAILURE OPERATION MODES

In the case of a brief power failure, the stove resumes the same operating functions that were set before the power failure occurred.

### **ON-Mode (Manual mode):**

The control switches into ST (Start Phase) and the stove then goes into ON mode.

### **TM-Mode (Automatic mode):**

The control switches into ST (Start Phase) and the stove then continues to run in TM-mode.

### **SB-Mode (Standby mode):**

The control switches into SB-Mode after approximately 2 seconds.

In the case of any power failure, a small quantity of smoke can escape from the stove. This should not last longer than three to five minutes.

## 2. OVERHEATING

If the stove overheats, an excess temperature switch (Hi-Limit) will shut-off the stove fuel feed.

After the stove has cooled down, the stove defaults back to the original control program. However, heating only continues if there are embers in the burn pot. If the stove does not re-ignite when fuel is fed again, then the shut-down process (cleaning, after-running phase) is carried out.

**ATTENTION: If overheating has occurred then maintenance, cleaning and inspection must be carried out by an authorized service technician.**

## 3. LOW TEMPERATURE SWITCH OFF

If the stove cools down below minimum temperature, then the stove will go into automatic shut down mode.

## 4. AUGER MOTER

**When the hopper lid is raised, the auger motor will stop feeding pellets, this safety feature is installed to protect from potential injury from the auger shaft.**

**\*Please note this stove will only operate with the hopper lid closed.**

## GENERAL



**ATTENTION!** Only work on unit when the power cord has been unplugged from the wall.

Your stove must be switched off and have cooled down before carrying out any work on it.

During assembly do not drop any items (screws) etc. into the hopper. Foreign items will block the auger and damage the unit.

## SIDE CLADDING

1. Place the sidepieces on the mounts provided on the base.
2. Push the side against the stove until it stands vertically.
3. Then, fasten inside the hopper at the top, using two (2) screws.

Repeat this procedure on the other side of the stove.

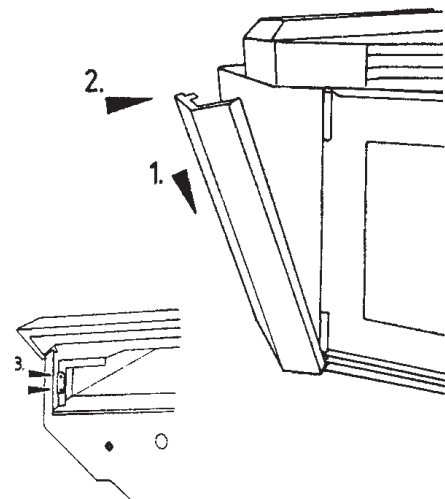

## CONTROL AND CONTROL BOARD

The INTEGRA II pellet stove has an electronic control fitted internally in the stove and a control board that is fitted to unit cladding.

The control (main board) and the control board may only be altered by specially trained dealers or service department. Improper handling of these parts will lead to the warranty becoming null and void.



# INSTALLATION INSTRUCTIONS INTEGRA II INSERT



It is recommended that only an authorized dealer install your pellet stove.

Before installing, contact your local building or fire officials about restrictions and installation inspection requirements in your area. Manufacturer and distributor have no control over the installation of the stove and assume no responsibility for any special, incidental or consequential damages.

## Design Guidelines for the Exhaust System

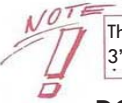

The stove must be connected to an approved 3" or 4" pellet vent chimney.

## DO NOT INSTALL A FLUE DAMPER IN THE EXHAUST VENTING SYSTEM OF THIS UNIT!

## DO NOT CONNECT THIS UNIT TO A CHIMNEY FLUE SERVING ANOTHER APPLIANCE!

The exit terminal must be located no less than 60 inches from any opening through which combustion products could enter the building (i.e. windows and doors), no less than 24 inches from an adjacent building, and no less than seven foot above grade, when located adjacent to public walkways. It must be arranged so that exiting flue gases will not be a hazard to people, overheat combustible structures, or enter the building.

The total length of the horizontal vent must not exceed 30 feet. The "PL" vent exhaust system must be installed and sealed with 3 screws per joint. The chimney manufacturer's installation procedures must be followed. In addition, pipe connections, joints, and all pipe seams within the home should be sealed with high-temperature silicone sealer, (RTV) aluminum tape.

## ELECTRICAL CONNECTION

The stove is supplied with an approx. 7' to 8' long connecting cable. This cable is to be connected to a normal 110 V, 60 Hz electrical connection. The average power consumption is approx. 100 watts. During the ignition process (duration 10 minutes) approx. 300 watts. The connection cable must be run so that any contact with hot or sharp-edged external surfaces on the stove is avoided.

## COMBUSTION AIR

Each combustion process requires oxygen or air. As a rule, the combustion air is taken from the living area in the house. The air taken from the living area must be reintroduced. In modern homes, very tight fitting windows and doors mean too little air flows into the house for proper combustion. This situation becomes problematic due to additional ventilation in the house (e.g. in the kitchen and bath exhaust fans). Outside air is recommended, but not required, except in mobile home installation.

## Installation of Insert in combustible framework

Center stove in minimum opening of 25" high and 39" wide.

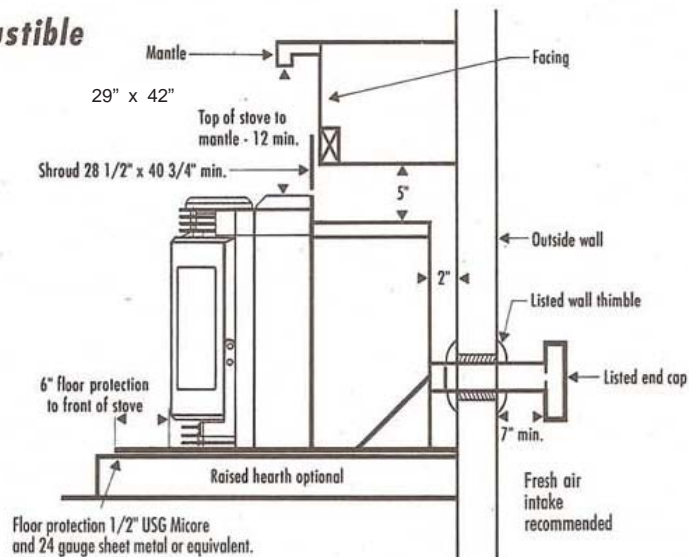

# INSTALLATION

## INTEGRA II INSERT

The Integra pellet stove may be installed in a variety of applications, as discussed below. The insert may be installed in a. listed, factory-built fireplaces; b. masonry fireplaces; c. a newly constructed combustible framework, or d. Custom Hearth® stand-alone fireplaces.

Do not remove brick or mortar from the fireplace to accommodate the insert. For masonry chimneys a direct connection from the exhaust to the first tile liner is required, and it is important that the flex pipe terminate no less than 12" above the air-tight seal. For a combustible framework, the opening must be a minimum of 25" high and 39" wide, with 2" of clearance to the back of the stove and floor protection of 1/2" USG Micore and 24 gauge sheet metal, or equivalent.



**HINT**  
A full reline vent system is not required but is recommended. Factory-built fireplaces and zero clearance fireplaces require a listed stainless steel liner from the exhaust to the termination of the fireplace chimney.

Floor protection in front of the stove must be a minimum of 3/8" thick, made of non-combustible material or equivalent, extending in front of the unit four inches and four inches to the sides at the front. The hearth extension clearance is six inches.



**NOTE**  
Before completing the installation by pushing the insert into its position in the fireplace, we recommend that the unit and all its components be fully assembled.

**SEE DRAWING**



For detailed information on the dimensions of the unit or questions about installation, please see drawing or consult your dealer.

### VENTING INTO AN EXISTING CHIMNEY

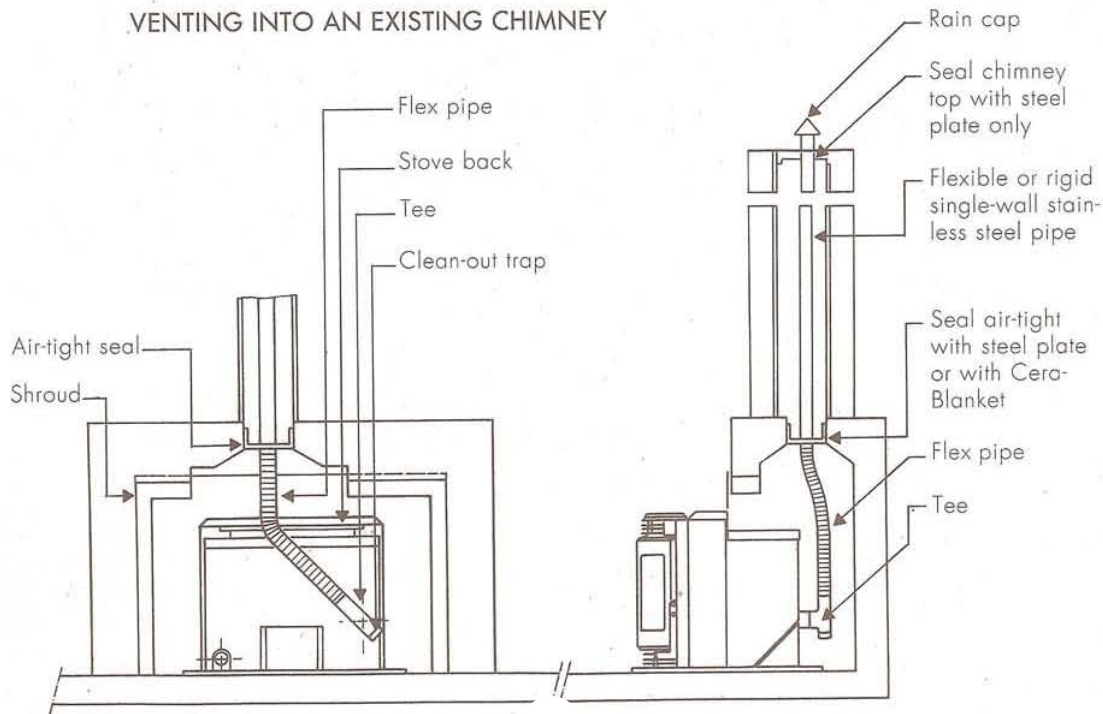

# INSTALLATION

## INTEGRA II INSERT

To determine whether a 3 inch or a 4 inch exhaust system should be used, follow the guidelines below.



1. Determine equivalent length of exhaust pipe in feet for proposed installation, using the following guidelines:

- Horizontal straight pipe = 1 x actual length ft.
- Vertical straight pipe = 0,5 x actual length ft.
- 90 degree elbow or tee = 5 ft.
- 45 degree elbow = 3 ft.

2. Determine whether a three or four inch pipe is necessary, based on equivalent pipe length, using the calculations above and the altitude of the installation found on the diagram below.

**Sample Calculation, Equivalent Pipe Length:**

- a) Horizontal pipe = 1 x (2 + 1) = 3 ft.
- b) Vertical pipe = 05. x 8 = 4 ft.
- c) 90 degree tee = 2 x 5 = 10 ft.
- d) 45 degree elbow = 1 x 3 = 3 ft.
- Total = 20 ft.

For example, if the stove is installed above 2,500 ft. altitude, a 4" diameter exhaust vent is required. Below 2,500 ft. altitude, a three inch or four inch diameter is appropriate.

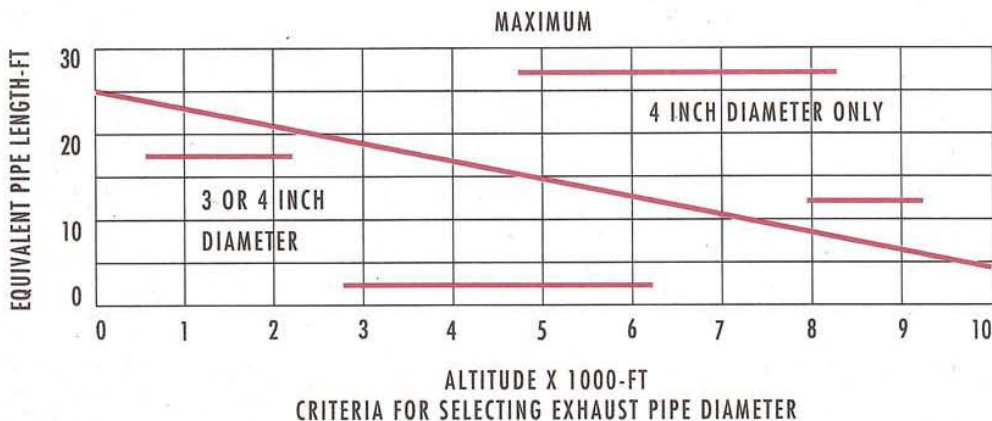

# A NEW HEATING PHILOSOPHY

In today's world, anyone manufacturing and marketing heating appliances has more than just the responsibility of producing a quality, safe product. It is essential that wood heating appliances apply technology which is environmentally friendly and, at the same time, extremely efficient.

Austroflamm is 100% committed to this obligation. Austroflamm continues to do research and development in pellet stove combustion technology. This gives you, as an Austroflamm customer, the assurance that you are buying the most advanced product available in the marketplace.



## WHY HEAT WITH PELLETS?

Chemically speaking, burning wood is the same process as wood rotting by itself. Rotting wood as well as burning wood releases  $\text{CO}_2$ . It is  $\text{CO}_2$  that trees need to grow, and, therefore, burning wood has no negative impact on the  $\text{CO}_2$  cycle. Heating with pellets means that the burning process is very carefully controlled, and wood is added to the combustion process only in precise quantities. This results in the optimized and therefore environmentally friendly incineration of wood. In the past,

waste wood products were simply discarded into local landfills to rot. Heating with pellets is an economical and a distinctly advantageous alternative to dumping. It is a natural and intelligent method of recycling. Heating with your Austroflamm pellet stove is designed to be easy and user-friendly. Because of its exceptionally large hopper, low pellet consumption, and very simple control panel, your Austroflamm pellet stove is, indeed, easy and convenient to operate.

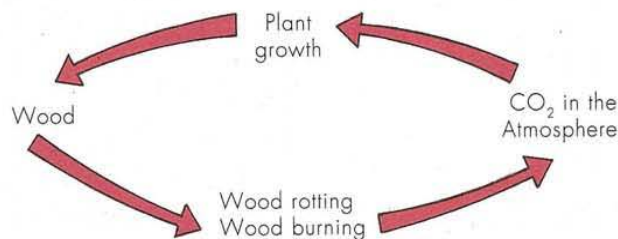

# WHAT ARE PELLETS?

The Austroflamm „Integra“ is a pellet stove, designed to burn wood pellets. Pellets are made of waste material from saw mills, woodworking operations as well as dead wood from forestry operations. The wood pellet industry is organized through the association of the Pellet Fuel Institute, and it is recommended that only wood pellets, manufactured to the standards set by the P.F.I. be used with this stove. All pellets made to these standards are labelled with an official P.F.I. registration number on the bag. This guarantees the consumer that the fuel is certified as to moisture and ash content.

The P.F.I. allows two grades: standard and premium quality pellets. The important difference in these pellet grades is their ash content.

**Premium quality:**  
1% (or less) ash content

**Standard quality:**  
Up to 3% ash content

A higher ash content in the fuel means more combustion residue which, in turn, means shorter cleaning intervals. See Routine Maintenance .

SEE PAGE  
23

## ASH

It is highly recommended that you use the lowest ash-content fuel available. Fuel with a 3% ash content may require the stove to be cleaned as often as every day or two, whereas a fuel with a 1% ash content may only require cleaning once every one to two weeks. This ash - since it is a completely natural product - makes an excellent fertilizer for all your garden plants. However, it should be aged and "quenched" with water before use.

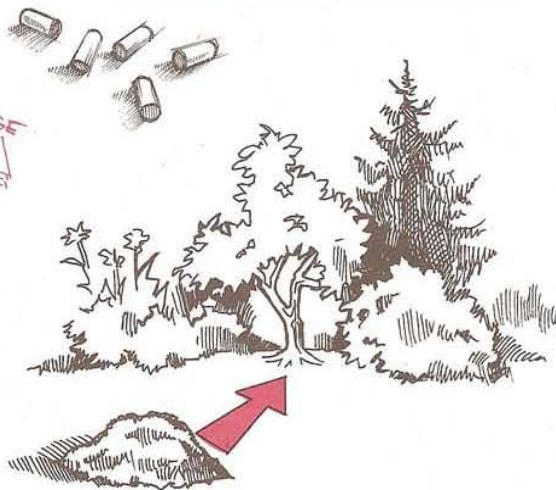

Please note that use of improper fuels will void your warranty and may cause damage or seriously affect the performance of your stove.



The current P.F.I. standards for residential pellet fuels are as follows:

	Standard Quality	Premium Quality
Heating value	8,200 BTU/lb. (minimum)	8,200 BTU/lb. (minimum)
Bulk density	40 lb/ft <sup>3</sup> (minimum)	40 lb/ft <sup>3</sup> (minimum)
Moisture content	8% (maximum)	8% (maximum)
Ash content	3% (maximum)	1% (maximum)
Size	1/4" - 5/16" diameter 1 1/2" long (maximum)	1/4" - 5/16" diameter 1 1/2" long (maximum)
Fines	0.5% (maximum) through a 1/8" screen	0.5% (maximum) through a 1/8" screen

Caution: Burning dirty or wet pellets or pellets containing salt contaminates the environment, imperils the function of your pellet stove, and may mean the loss of manufacturer's warranty.

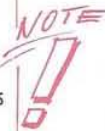

Caution, please: Embers may be embedded and hidden in the ash. Store in metal containers only!

## STORING PELLETS:

To guarantee that your pellets will burn without any problems, they should be stored in a dry and clean environment.

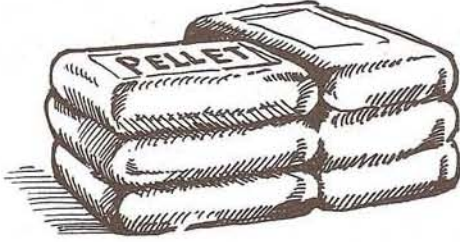

If you have any further questions regarding fuel for use in your Austroflamm stove, please contact your dealer or the .P.F.I.

Pellet Fuel Institute  
1601 N. Kent Street, Suite 1001  
Arlington, VA 22209  
Phone: 703/522-6778

## CLINKERING

„Clinkering“ is a process that takes place in the combustion pot. A clinker is a solid substance that accumulates due to heat and silica working together and forming deposits during combustion. Silica is actually sand and is present in all pellet fuels along with a variety of other impurities. When clinkering takes place, these hard substances will tend to clog the holes

at the bottom of the combustion pot. This adversely affects the performance of the stove as it cuts off the air supply to the combustion process. The burn pot should be checked periodically for clinkers, and all hard substances should be removed from it so as to allow proper air flow through the bottom. A tool is provided with your AUSTROFLAMM Integra pellet stove to be used in cleaning these holes. It should be noted that even P.F.I.-approved pellet fuels will cause some clinkering.

For more information about how often you need to clean your stove see page 23.

AUSTROFLAMM will not be responsible for damage caused by the use of inferior or improper grades of pellet fuels. AUSTROFLAMM is not responsible for the performance of the stove due to the use of non-approved fuels.

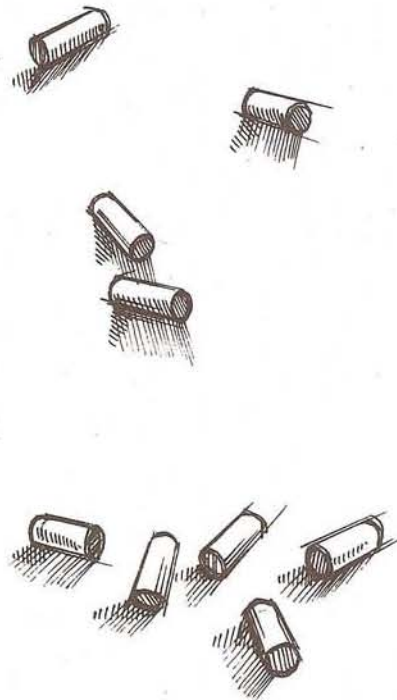
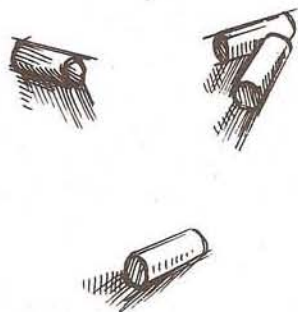



**DO NOT** start your stove until the venting installation is complete!

Your pellet stove is exclusively for burning pellets made from wood of a controlled quality. Non-pelletised solid fuels (straw, maize, chopped matter etc.) are not permitted. Failure to adhere to these guidelines could void your warranty.

When run correctly your pellet stove will not overheat. Improper operation can however shorten the life expectancy of the stove and its components

## CONTROL AND INTERNAL CONTROL UNIT - FUNCTION

Your pellet stove is equipped with a modern programmable microprocessor control. The user can preset the individual equipment functions via the internal control unit (keypad with operating display) fitted on the right hand rear wall.

The control (main board) and the control board may only be altered by trained specialist dealers or the service department. Improper handling of these parts leads to the guarantee and warranty becoming null and void.

**Your Austroflamm pellet stove is equipped with an electronic ignition start-up system. Starter fluids or gels are not necessary. Simply push the start button and the unit will ignite within a ten minute period.**

## Internal control unit

All settings and functions can be regulated via this unit.

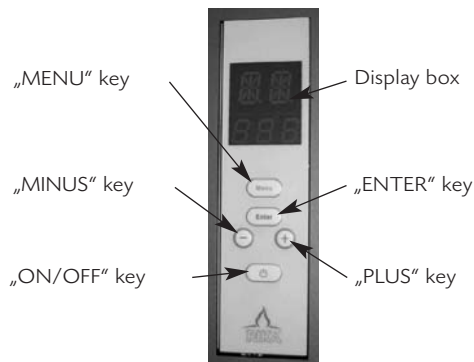

Fig. 1 Internal control unit, key assignment

### DISPLAY BOX:

Displays the operating modes in illuminated letters.

### MENU:

Navigation in and to the different sub-menu levels.

### ENTER:

Navigation in the main menus (SB; ON; TM) and confirming user entries.

### MINUS/PLUS:

Lowering or increasing user values.

### ON/OFF:

Switching the fire on or off.

# STARTING PROCEDURE

---

## Initial Start-up

Turn stove on, press enter button twice and SB will show in display box. Turn stove off and let it go through shutdown. At conclusion of shut down stove will return to SB mode now you can program.

Stove can be run in a manual or Time Mode (TM).

1. To run in manual mode press on/off button and stove can run manually.
2. At start-up stove will read ST/21. ST stands for start-up and 21 is start-up time. During start-up only the auger and combustion fan come on. Convection fan comes on 20 minutes after start-up. You now have control of stove.
3. Digital readout will read ON (for manual).
4. Under the ON is a number that reflects the fire intensity. The setting can be from 0 to 100. 0 being the lowest setting and still have the stove running.
5. Set these with the plus and minus buttons.

If stove needs to be turned off push on/off button and stove will go through shut down mode. When SB appears in digital readout shut down is complete.

## Time Mode

In TM mode the stove can be set to come on at programmed times. You can set 2 programs per day, and set heat intensity as well.

1. From SB push menu button.
2. MO(Monday) shows up in digital display.
3. Press enter and S1 is displayed and a number is displayed under S1. The number under S1 is the time (displayed as a 24 hour clock).
4. Press the 'plus' or 'minus' button to adjust start time. Time can only be set to come on in hourly increments and off in hourly increments.
5. Press enter and E1 is displayed. This stand for end of 1<sup>st</sup> heating period.
6. Press enter again and S2 is displayed. This for the second heating period. Set as in S1.
7. Press enter and E2 appears. Set end time as in E1
8. Press enter and display returns to MO
9. Press Menu and the next day (TU) will appear. Program according to needs. Do this for the remaining days.

# STARTING PROCEDURE

---

## **Setting heat modes and time**

1. After setting E2 value for SU (Sunday) by pressing enter now press the menu button.
2. PS (Power start) will appear in the display. Under PS will be displayed a number this is for heat intensity. Press 'plus' or 'minus' to set heat intensity 0 being the lowest up to 100 (highest).
3. Press enter to confirm values.
4. The display will now show PE (Power end) with the word 'off' under PE. Off means the fire is switched off between heating programs. If you want the stove to run at a low setting between heating programs use the 'plus'/'minus' to set the heat output.
5. Press enter again and the values are saved.
6. The display now reads CL(cleaning cycle) and 60 under the CL. Once each hour the stove will ramp up to the heat setting for 1 ½ minutes to clean out the burn pot. After which it will return to its original setting. This can be changed by pressing the 'plus' or 'minus' button. We highly recommend leaving this at 60
7. Press enter and VA (software version). Under this will appear the software version 1.22,ie.
8. Press menu and H (hour) appears with a number below on the display. This a 24 hour clock using the 'plus' 'minus' buttons sets hour.
9. Press enter and M (minute) appears using the 'plus' 'minus button set minutes.
10. Press enter and D(day) appears in the display. Set the current day by pressing 'plus' or 'minus' (1=Monday, 2= Tuesday etc.) Press enter confirming the new values.
11. Press Menu and return to SB (stand-by)

## BASIC INFORMATION



Your stove must be switched off and have cooled down before carrying out any maintenance activities.

The frequency your unit must be cleaned as well as the maintenance intervals depends on the fuel and the amount of usage.

High moisture contents, ash, dust and chips can more than double the necessary maintenance intervals.

We would like to point out once again that you should only use tested and recommended wooden pellets as a fuel.

### POKER

A poker is supplied with your new pellet stove.

Please use this poker for:

1. Cleaning the heat exchanger.
2. Cleaning the burn pot.
3. Loosening the pellets in the pellet burn pot should they stick to the side walls;

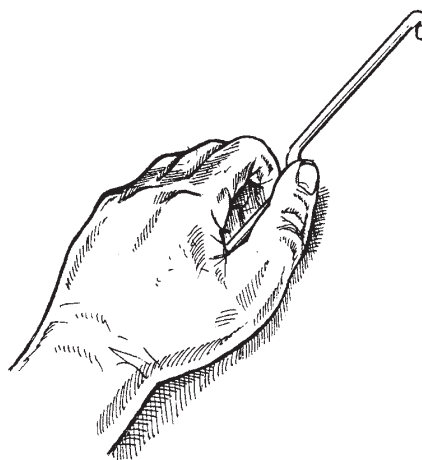

### DAILY

#### BURN POT

The burn pot should be looked at to ensure that ash or clinker does not block the air feed openings. The burn pot can easily be cleaned when in position. After removing the pan the area underneath can be vacuumed free.

1.

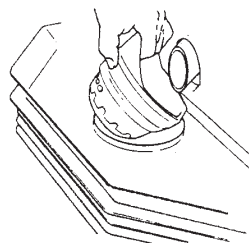

### DAILY

#### HEAT EXCHANGER

Two cleaning rods are located directly under the front cover piece these are used for cleaning the heat exchanger (remove lid). To maintain the maximum heating efficiency, these rods should be pulled up and down several times. This removes the flue ash from the heat exchanger tubes, and increases heat transfer to the room.

2.

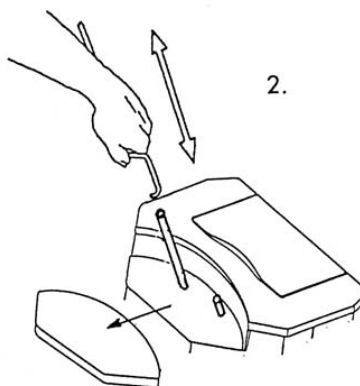

## ASHTRAY

Empty the ashtray as required. It must only be removed when the stove is switched off and cooled down.

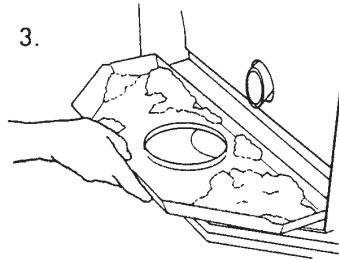

Please TAKE CARE: Remove embers into metal containers, ONLY

Vacuuming using the ash pan is recommended to remove the ash.

## GLASS CLEANING

The best way to clean the glass is using a damp cloth or stubborn dirt can be removed using the glass cleaner (obtainable from your local dealer).

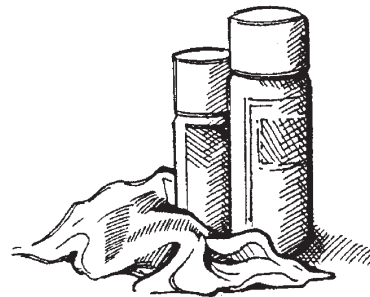

## HEAT EXCHANGER OUTLETS (if used frequently)

Remove the upper and lower cast walls in the rear of the firebox as shown.

Hex head tool provided.

Vacuum the area thoroughly.

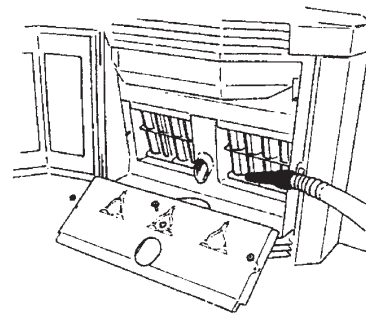

## Rear Ash Chamber

Remove the rear ash trap door located behind the right side rear panel. Vacuum the chamber that extends across to the combustion motor housing. Pay close attention to the pass through holes coming from the front of the heat exchanger area and make sure they are clean and clear from any obstruction. If these holes are blocked the unit will not operate properly and might not run at all. This should be checked for every 1 ton of fuel to see if the cleaning intervals might be increased or decreased. Fuel quality and extended low burn rates will increase the frequency required.

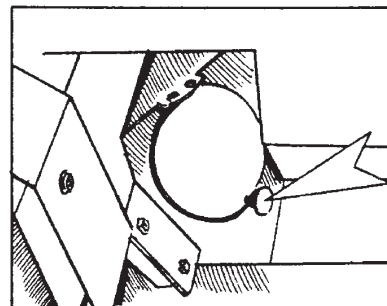

## Combustion Motor Housing

This maintenance procedure should be done on a regular basis depending on fuel quality and amount of useage.

In order to inspect the combustion fan and to clean it, remove four screws (see drawing) and pull the motor out of the housing carefully. Remove the ash from fan and outlets using an approved vacuum cleaner.

**Replace the combustion motor gasket as required.**

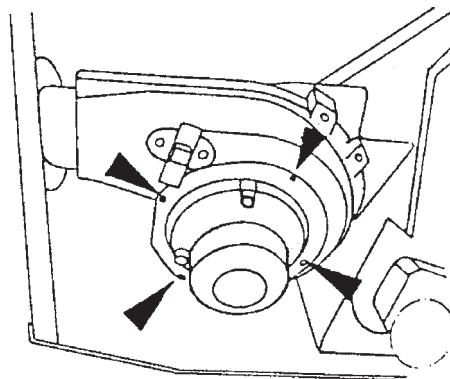

Only carry out maintenance when the power cord has been removed from the wall.

Note: All motors have sealed ball bearings.  
Lubrication is not required!

## HOPPER

At least once a year, allow your hopper to empty completely and vacuum out the bottom of the hopper assembly.

## Door Gasket

The condition of the gasket on the doors and glass should be checked from time to time. Repair or replace in order to maintain air tight seal.

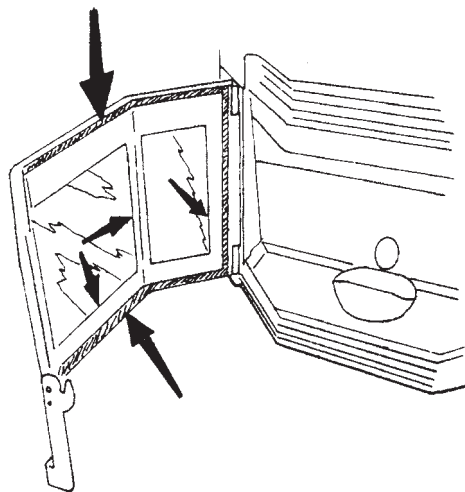

## EVERY SIX MONTHS FLUE CONNECTION

Inspect and clean the chimney system. The collected ash can have a negative effect on the stove performance and represent a safety risk.

## AIR SENSOR

The air sensor should be maintained and cleaned by an authorized service technician. Cleaning should be carried out using a non-petroleum based electronic spray.

# FAULTS - CAUSES - SOLUTIONS

## PROBLEM

The fire is burning with a weak, orange flame. Pellets are building up in the burn pot windows are covered with soot.

### Cause:

1. Inadequate combustion air

### possible solutions:

1. Remove any ash or clinker that is blocking the air inlet openings, from the burn pot. If possible change over to a better pellet quality.
2. Check if the flue gas outlet is blocked with ash (see "Maintenance" page)
3. Check if the air inlet channel or flue tube is blocked
4. Check the door gasket for leaks
5. Clean the impeller on the combustion motor
6. Have the unit serviced by an authorized dealer or technician

## PROBLEM

Fire goes out or the unit switches off automatically.

### Cause(s):

1. Pellet hopper is empty
2. Auger is jammed
3. High limit switch(upper temperature limit) was triggered
4. Doors leaking or not closed properly
5. Hopper lid left open
6. Pellet feed rate too low
7. Thermal switch (lower temperature limit) was triggered

### possible solutions:

1. Fill up pellet hopper
2. See the following section "Pellets not fed in"
3. Leave the unit to cool down for an hour and then start again
4. See "Maintenance" and "Cleaning"
5. Change fuel brand

## PROBLEM

Pellets were not feeding

### Cause(s):

1. Pellet hopper is empty
2. High limit switch faulty
3. Auger is blocked (objects, wood etc.)

### possible solutions:

1. Check the container contents, if necessary refill pellets
2. Have your authorized dealer determine the fault
3. Clean the pellet hopper and the auger system.

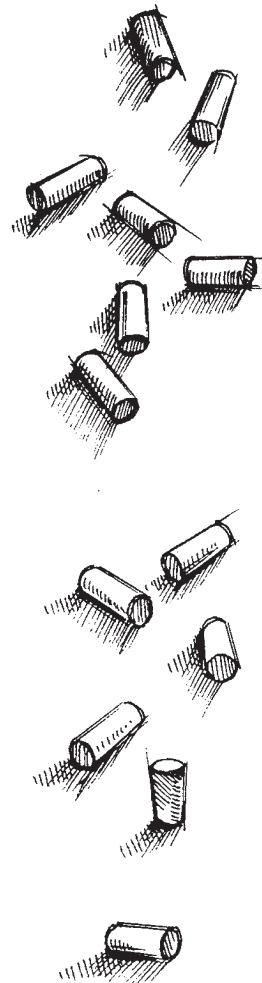

## **COMBUSTION PROBLEM**

**Fan not running.**

**Cause(s):**

1. Unit not receiving any power.
2. Control board not receiving any power

**possible solutions:**

1. Check if the stove plug is inserted in the wall socket, check if the current circuit breaker on the electrical control panel has been triggered.
2. Look at the fuse in the back of the stove.

## **PROBLEM**

**Soot or ash outside of stove.**

**Cause(s):**

1. Combustion chamber doors open when the fire is on
2. Leaks in the seams between the combustion fan and venting;  
Signs of this are the dust on the convection fan and in the heat exchanger tubes or dust on the floor behind the unit.
3. Check inside venting for possible leaks at the joints. Make sure the joints are sealed with high temperature silicone or metallic tape.

Possible Solutions:

1. Always keep the combustion chamber door closed and if possible only open when the stove is not on.
2. Check the chimney joints for proper seal starting at the combustion motor housing.

## **User Board Error Messages**

If the stove stops because it is programmed to do so (e.g.: Pellet hopper empty, excess temperature protection triggered, low temperature protection message, air sensor faulty, combustion problems (e.g.: slag in the combustion pan, leaking combustion chamber door, glass in the combustion chamber door broken, etc...)) the display shows: the error message "Err" (Error).

When an error message occurs the corresponding cause must be corrected before the stove can be started again by pressing the on-off. Contact your authorized service technician for repair.

## KEY WORD - LIST OF ABBREVIATIONS

Key word / Abbreviation	Name	Description
SB	Standby-Mode	Standby mode (fire switched off, but active)
ON	ON-Mode	Manual operation
TM	Time-Mode	Automatic operation
MO, TU, WE, TH, FR, SA, SU	Weekdays	Monday to Sunday
S1, S2, E1, E2	Start 1, Start 2, End 1, End 2	Heating start times, heating end times for automatic mode (TM)
PS	Power-Start	Output value from the beginning of heating time in TM-Mode
PE	Power-End	Output value from the end of heating in TM Mode
CL	Clean	Cleaning mode
V	Version	Controller software version
H, M, D	Hour, Minute, Day	Hour, minute, day memory for internal clock
ST	Start	Pre-heating program run
EX	Exit	Exit program run
MENU	Menu botton	Navigation in and to the different sub-menu levels
ENTER	Enter key	Navigation in the main menus (SB; ON; TM) and confirming user entries.
+/-	Plus/ Minus-key	Increasing or lowering user values
ON/OFF	ON / OFF key	ON/OFF

There is expressly no warranty on the following components:

- Glass
- Paint
- Metal Plating
- Gasket Material
- Burn Pots
- Ceramics
- Natural Stone



The Manufacturer provides a five-year limited warranty on all steel parts (except the burn pot) and a two year limited warranty on all electrical components. These warranties commence on the date of the original purchase.

**An optional five year extended warranty on all electrical components is available.**

This warranty covers defects in materials and workmanship in covered components, provided the product has been installed and operated strictly in accordance with the Manufacturer's printed instructions. This warranty does not cover damage or breakage caused by improper handling, misuse, or unauthorized modification. Without limiting the foregoing, the use of fuel other than wood pellets and improper installation of the product voids all warranties.

**AUSTROFLAMM/HPG**  
**8111 NE Columbia Blvd.**  
**Portland, OR 97218**

**INCLUDE:**

1. Name, address, and telephone number of purchaser.
2. Name, address, and telephone number of seller, date of purchase, and proof of purchase.
3. Name, address, and telephone number of installer and date of installation.
4. Serial number of stove.
5. Nature of defect, malfunction, or complaint.

Arrangements will be made for inspection. If the inspection indicates that the failure was due to defective material or workmanship in covered components and that the other terms and conditions of this warranty have been complied with, the Manufacturer's sole duty and liability under

this warranty shall be limited to the Manufacturer's replacement or repair, at Manufacturer's option, of the defective unit or part. The purchaser shall assume all costs of shipping to and from the Manufacturer or his agent and shall be responsible for all losses incurred during shipment. Removal and reinstallation costs are not covered under this warranty. Neither the Manufacturer nor the supplier to the purchaser accept responsibility, legal or otherwise, for incidental or consequential damage to property or persons resulting from the use of this product. Any warranty implied by law, including, but not limited to, implied warranties of merchantability or fitness, shall be limited to one year from the date of the original purchase. Whether a claim is made against the manufacturer based on a breach of this warranty or any other type of warranty, expressed or implied by law, the Manufacturer shall in no event be liable for any special, indirect, consequential, or other damages of any nature whatsoever in excess of the original purchase price of this product. All warranties by the Manufacturer are set forth herein, and no claim shall be made against the Manufacturer based on any oral warranty or representation.

Some states do not allow the exclusion or limitation of consequential damages or limitations of implied warranties, so the limitations or exclusions set forth in this warranty may not apply to you.

**WARNING**

Changes to the design characteristics or operating parts are not authorized by the Manufacturer and will void any and all warranties. Such changes may create hazardous conditions which can endanger the user and/or his property.

This warranty gives you specific legal rights, and you may also have other rights which vary from state to state.

**WARRANTY LIMITATIONS:**  
 MANUFACTURER, DISTRIBUTOR AND SUPPLIER MAKE NO OTHER WARRANTIES, EXPRESS OR IMPLIED, INCLUDING ANY WARRANTY OF MERCHANTABILITY OR WARRANTY OF FITNESS FOR A PARTICULAR PURPOSE.

**LIMITATION OF LIABILITY:**  
 MANUFACTURER, DISTRIBUTOR AND SUPPLIER SHALL NOT BE LIABLE FOR ANY INCIDENTAL OR CONSEQUENTIAL DAMAGES TO PROPERTY OR PERSONS ARISING FROM OR RELATED TO USE OF THIS PRODUCT. USER'S SOLE AND EXCLUSIVE REMEDY FOR ANY NONCONFORMITY IN THE PRODUCT OR ANY CLAIM RELATED TO THE USE OF THE PRODUCT SHALL BE, AT MANUFACTURER'S OPTION, REPAIR OR REPLACEMENT OF THE PRODUCT OR RETURN OF THE PURCHASE PRICE FOR THE PRODUCT.

**WARRANTY CARD**



8111 NE Columbia Blvd.  
Portland, OR 97218



NO POSTAGE  
NECESSARY  
IF MAILED  
IN THE  
UNITED STATES



**BUSINESS REPLY MAIL**

FIRST-CLASS MAIL PERMIT NO 911 PORTLAND OR

POSTAGE WILL BE PAID BY ADDRESSEE

AUSTROFLAMM / RIKA  
8111 NE Columbia Blvd.  
Portland, OR 97218-9901



**This warranty registration guarantees your coverage.**

To register your new RIKA stove, completely fill out the card below:  
Fax it: 1-800-777-7069 or  
Mail it: Postage is already paid.

Warranty Proof: Your registration serves as proof of purchase for your warranty coverage. Please make sure the card is completed in order to guarantee coverage.



AUSTROFLAMM/RIKA Customer Service: 1-800-777-5594 FAX: 1-800-777-7069

MR.  MS.  MRS.

FIRST NAME LAST NAME

COMPANY NAME

ADDRESS

CITY STATE ZIP CODE

PHONE E MAIL

DEALER NAME

DEALER PHONE FAX

DEALER CITY STATE ZIP CODE

DATE OF PURCHASE MODEL

**Serial Number Information (required)**

Pellet Stove Serial #

Pellet Stove Serial # Pellet Stove Serial #

Wood Stove Serial # Wood Stove Serial #

Wood Stove Serial # Wood Stove Serial #

**WHERE DID YOU HEAR ABOUT AUSTROFLAMM/RIKA?**

Friend  Received information from DLRS

Dealer Recommendation

Magazine (please specify) \_\_\_\_\_

Other (please specify) \_\_\_\_\_



**Warranty Registration**

